

INTERNAL AND EXTERNAL ACTIVATION IS SUBJECT TO PROJECT SPECIFICATION. CABLE ROUTES IF REQUIRED ARE TO BE BY OTHERS

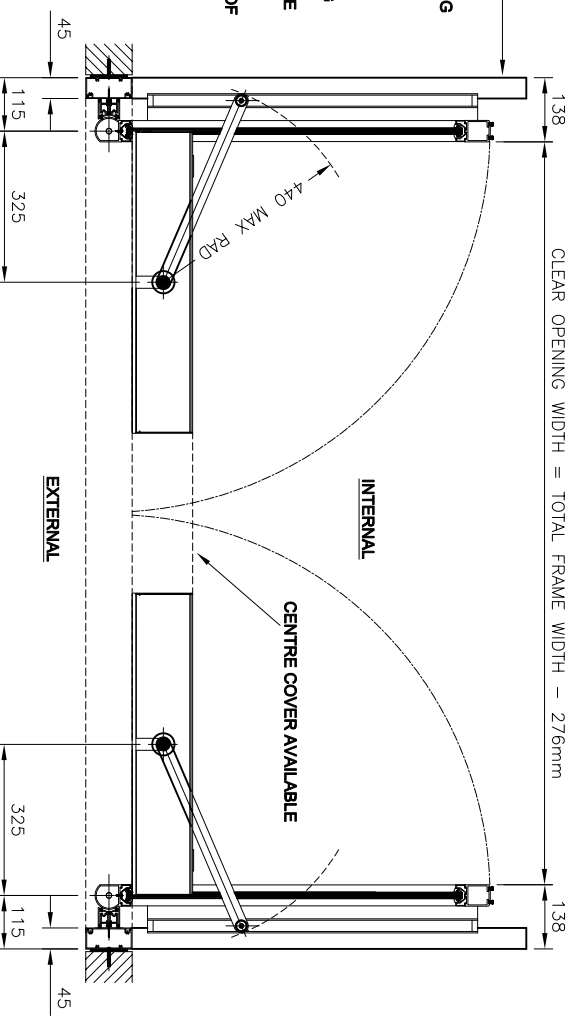
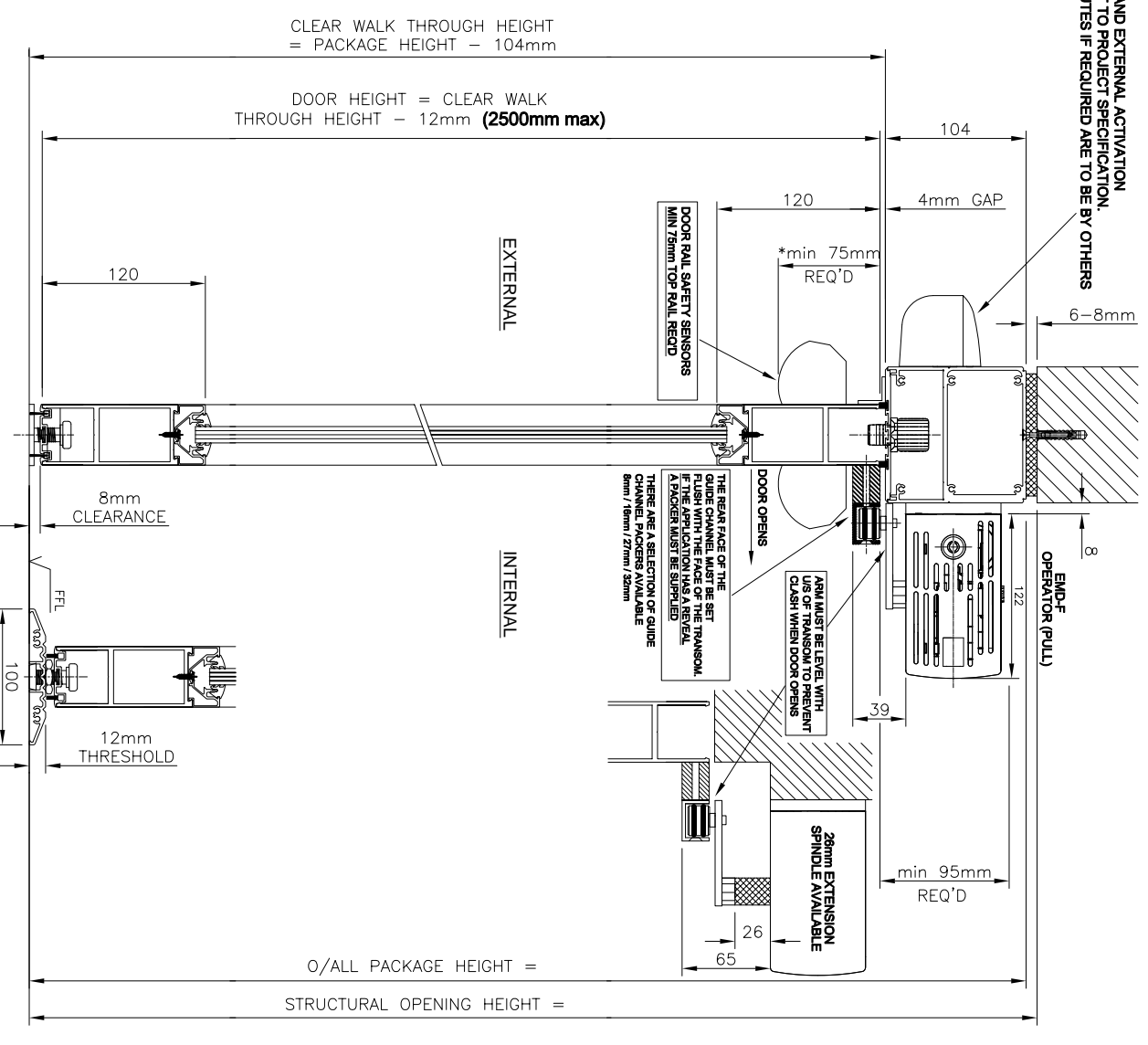

- BARRIERS MAY BE REQUIRED**
- a) TO SAFEGUARD AGAINST PEDESTRIAN TRAFFIC APPROACHING FROM THE SIDE INTO THE SWEEP AREA (OPENING AND CLOSING) OF THE SWING DOOR.
  - b) TO DIRECT PEDESTRIAN TRAFFIC TOWARDS THE DOORWAY OPENING
- PLEASE NOTE BARRIERS SHOULD BE POSITIONED IN SUCH A WAY THAT THEY DO NOT CAUSE AN OBSTRUCTION, OR INHIBIT MEANS OF ESCAPE OR REDUCE THE CLEAR OPENING.

This drawing shows the actual stage of product development for this door indicated. It is not intended to be used for construction purposes. An option is available to provide a drawing for the construction of the door. All options are available to be included in the drawing. The drawing remains the property of GEZE and is not to be used without the express consent of GEZE.

**PROJECT SPECIFIC DETAILS**

PROJECT :	
FINISH :	
GLASS :	
LOCKING :	
CONTROLS :	
ACTIVATION :	
SAFETY :	

Revision	Drawn	Date	Reason for Change
A	GH	20/1/09	SPINDLE EXT DETAIL REVISED

Drawing No. EMD-01		Title EMD TRANSOM MOUNT PULL (GUIDE CHANNEL) - Pair with doors & frame in Alum profiles (single glazed)	
Drawn GH	Appd NTS	Scale NTS	Date JUL 08
www.geze.com		Lichtfield Staffordshire, TEL 01543 443000 WS13 8SY FAX 01543 443001	

